

HELI

ELECTRIC FORKLIFT TRUCK 1-3.5t



THE FEATURES OF THE CPD10-35H-B

- New type of lower speed and bigger torque DC serial lifting motor.
- Excellent performance MOSFET lifting speed controller.
- New type of low noise pump which is adopted the splitting-teeth technology.
- New technology of dynamic signal load sensing in hydraulic system.
- New type of integrated steering unit with the load sensing.
- Emergence power shut-down.
- Lifting speed being controlled steplessly.
- Electric controller self-protecting.
- Preventing abnormality operating.

H2000
SERIES

CPD10/15H-B
CPD18H-B
CPD20/25H-B
CPD30H-B
CPD30H-C
CPD35H-B



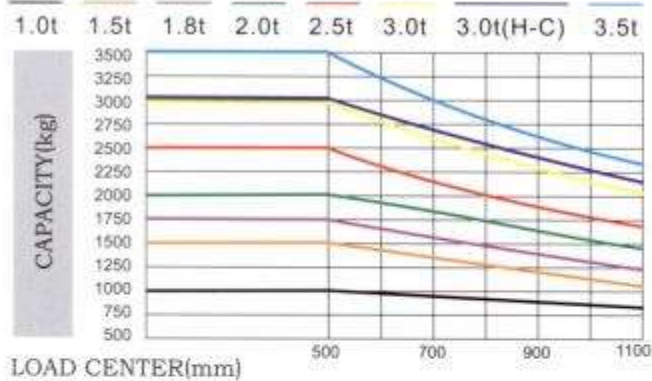

Notice:

Vertical axle stands for load capacity while horizontal axle stands for load center. Load center is the distance counted from the front of the fork. The base point of the standard load is the center point of the cubic with the same 1000mm dimension in length, width and height. The load capacity should be down, if mast tilts forward, using non-standard forks or loading goods with extra width. Please notice the different load capacity between different load centers according to load chart.

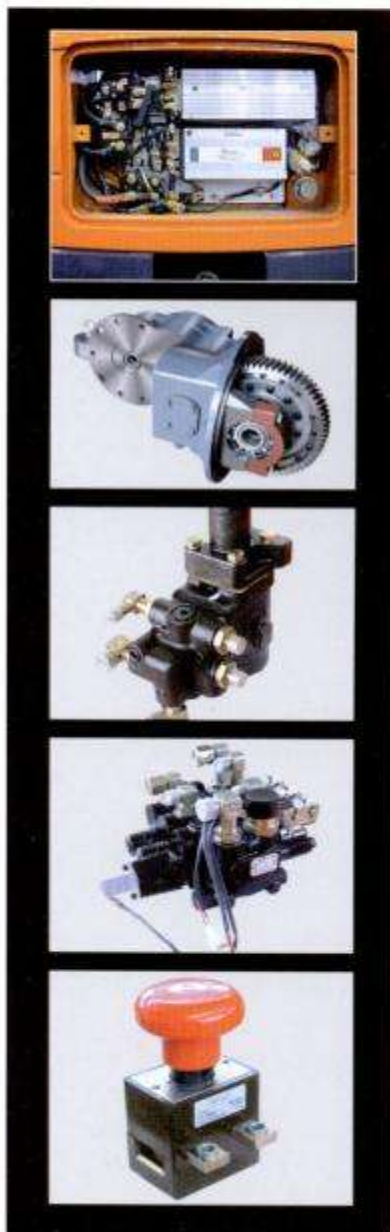

SAFETY

Except function of the truck's electric controller should be protected, CPD10-35H-B series yet has many other protection measures, such as function of preventing abnormality operating, seat power shut-down function, emergence power shut-down function and the steering function being hold while traveling and brake pedal being pressed etc. This series also has ability of the mast speed being controlled steplessly, and the max. travel speed being selectable. This series conforms to the relevant EU Guideline CE for industrial trucks.

RELIABILITY

CPD10-35H-B series has been effectively considered the circumstances of users operation at the beginning of products design, and the important plugs and switches all have measures of protection, all the subassemblies have been past the check strictly, and the very important parts and subassemblies also have been past the fatigue and lasting experiments. Ultimately every truck has been past the performance-examine strictly.

HIGH EFFICIENCY

CPD10-35H-B series is adopted an excellent performance DC serials motor in design, which increases the lifting speed of no load, enhances productivity of the truck. This series yet is adopted advanced technology of dynamic signal load sensing in hydraulic system, which makes the truck hydraulic system is more efficiency and more energy saving.

LOW NOISE

CPD10-35H-B series is adopted a new type of integrated steering unit with the load sensing, eliminate the steering motor and steering pump, achieved hydraulic system driven by only single pump. This series is adopted the excellent performance DC motor and the low noise pump, it is remarkably decrease noise of the driving and action of low speed lift, and the truck is more green to environment.

STANDARD DISTRIBUTION

Mast with wide view	Battery group	Four tyre
Standard fork	Standard seat	Traction bar
II (III) fork holder	Overhead guide	Relevant tools
Fork bracket	Overhead guide raincoat	
Control valve	LCD compound displayer	

OPTIONS AND ATTACHMENTS

Cab	Load stabilizer	Widened fork holder
Boom	Sleeve on fork	Steel protection net
Paper clip	Suspend seat	Multi function barrel clip
Load bar	Turning flat clip	Colored tyre (white, green)
Solid tyre	Alarm lamp	Tilt cylinder protection sleeve
Side shifter	Rear work light	Damp fork, damp container
Load hawk	Lengthened fork	Accessory hydraulic component
Turning fork	Back view mirror	Wide view triplex mast with full free length
Load pusher	By-tyres protector	Wide view double mast with full free length

Note:

HELI industrial trucks are equipped with certain safety devices as standard equipment.

HELI will not assume any liability for damage arising from or caused by the removal of any safety devices from any of its products.



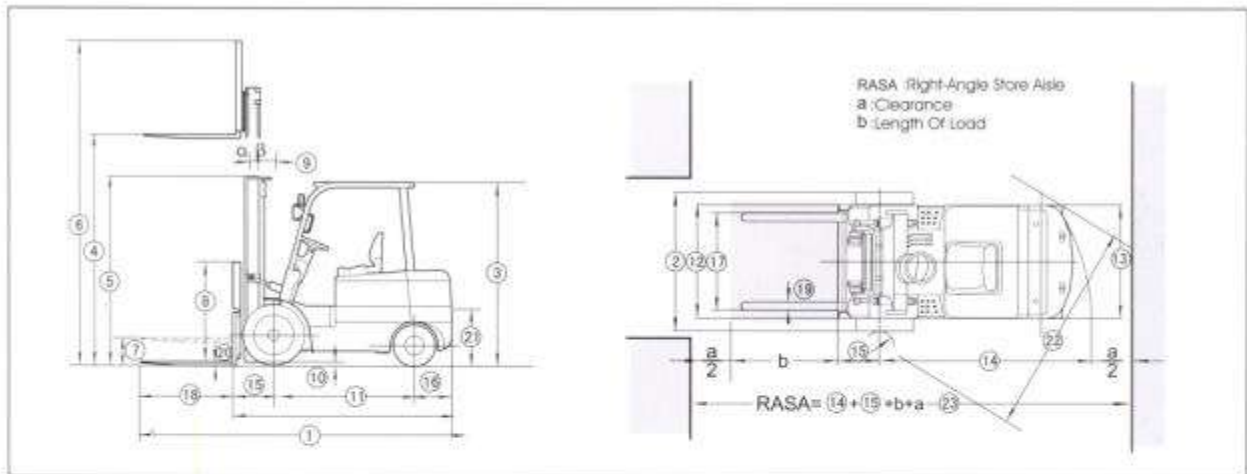

DIMENSION (FRONT SINGLE TIRE, WITH WIDE VIEW MAST)

Model	CPD10/15H-B	CPD18H-B	CPD20/25H-B	CPD30H-B	CPD30H-C	CPD35H-B
	mm	mm	mm	mm	mm	mm
① Overall length (with forks)	3045	3075	3465	3620	3728	3750
② Overall width	1070	1070	1150	1225	1225	1225
③ Overall height (overhead guard)	2160	2160	2130	2150	2150	2150
④ Max. Lifting height	3000	3000	3000	3000	3000	3000
⑤ Overall height fork lowered (upright)	1995	1995	2145	2145	2145	2180
⑥ Overall height fork raised (with backrest)	4030	4030	4330	4250	4250	4250
⑦ Free lift	150	150	135	305	305	300
⑧ Backrest height (from upper face of forks)	960	960	1000	1220	1220	1220
⑨ Tilting angles (forward-backward)	6° - 12°	6° - 12°	6° - 12°	6° - 12°	6° - 12°	6° - 12°
⑩ Min. under-clearance (bottom of mast)	105	105	115	135	135	135
⑪ Wheel base	1370	1370	1515	1600	1720	1720
⑫ Tread(front)	890	920	960	1000	1000	1000
⑬ Tread (rear)	920	920	950	970	970	970
⑭ Outside turning radius	1930	1960	2065	2250	2410	2430
⑮ Fork overhang	418	421	483	498	498	495
⑯ Rear overhang	335	365	400	450	440	465
⑰ Lateral fork adjustment (Outside of fork)	200-950	200-950	245-1025	250-1090	250/1090	250/1090
⑱ Fork length	920	920	1070	1070	1070	1070
⑲ Fork width	100	100	122	125	125	125
⑳ Fork thickness	31/35	38	40	45	45	50
㉑ Coupler height	335	335	355	350	350	350
㉒ Min. intersecting aisle	1890	1920	2030	2090	2400	2423
㉓ Min. Right Angle Stacking Aisle Width (Pallet size: 1m X 1m, Clearance 0.2m)	3550	3585	3750	3950	4105	4125
㉔ Min. Right Angle Stacking Aisle Width (Pallet size: 1.2m X 1.2m, Clearance 0.2m)	3740	3780	3950	4150	4310	4325

HELI products and specifications are subject to improvement and change without notice.

HELI MANUFACTURER: **ANHUI HELI CO., LTD.**
DISTRIBUTOR: ANHUI HELI INDUSTRIAL VEHICLE IMPORT & EXPORT CO., LTD.

SOLD BY:

TEL: (0086) 551-3639468, 3632133, 3648005

FAX: (0086) 551-3639966

P.C: 230022

Add: 15, Wangjiang West Road, Hefei, China

E-mail: heli_jck@heliforklift.com

Web site: <http://www.helichina.net>

A-2-0603